

## OUTSIDE DRAWING

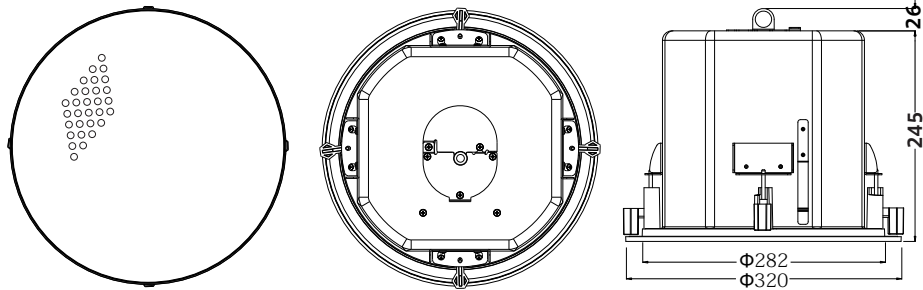

## MOUNTING SIDE TYPE:

1. Cut a 290mm hole in the ceiling.

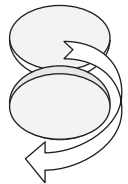

3. Remove the product mesh.

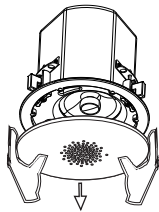

5. Reinstall the net.

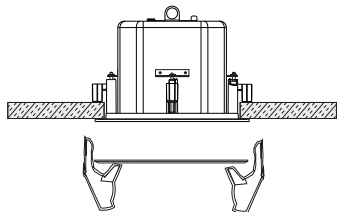

2. Secure the safety rope to the rebar or bolt near the horn opening to prevent the horn from falling.

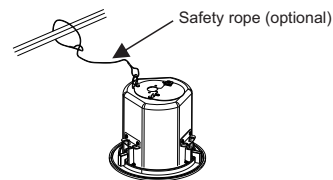

4. Connect the audio signal cable, install the product on the ceiling according to the pre-opened hole, and screw to fix the tongue to the ceiling.

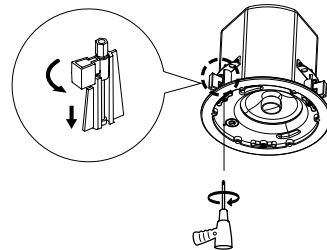

Ceiling Speaker

# OPERATING MANUAL



(Appearance is for reference only, see the physical)

Manufacturer: Guangzhou Ruifeng Digital Technology Co., LTD  
Address: No. 10, Shiliou Section, Lian Road, Shiliou Town, Panyu District, Guangzhou City

# TOP SUCTION SPEAKER SYSTEM

## Series application

A place in a store, department store, school, office, hotel, restaurant

## Product features

- Extraordinary speech and music reproduction effects
- High strength material housing
- Simple and convenient power setting
- Convenient installation, flexible assembly
- Meet CE standard

## Schematic diagram

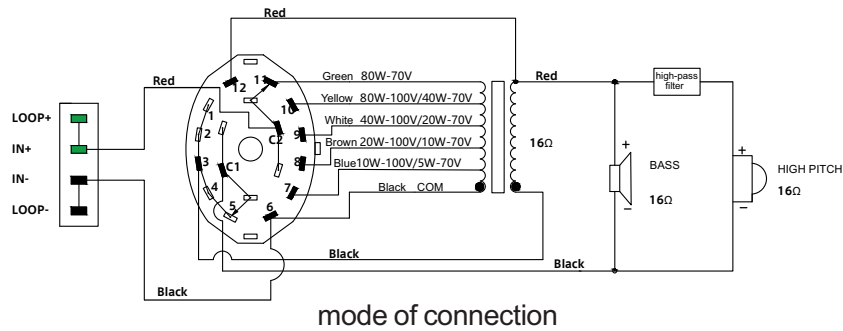

## Product curve diagram

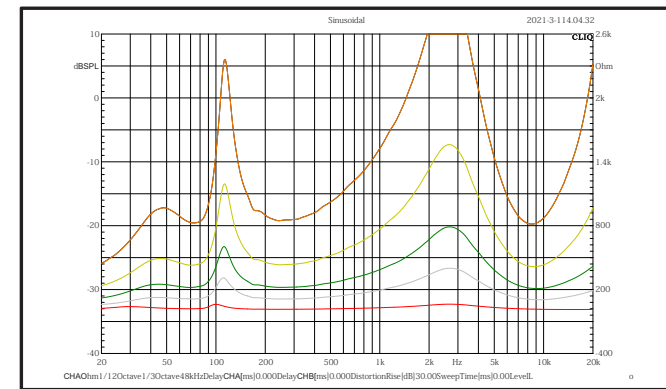
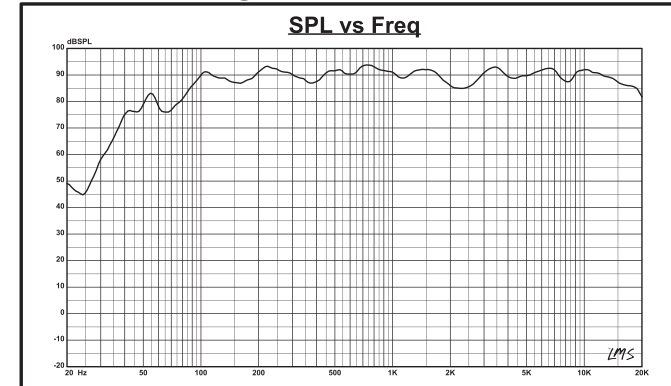

## Technical specification

Frequency Response	80Hz ~ 20kHz
Sensitivity (1W/1M)	90dB
Nominal Resistance	1KΩ/500Ω/250Ω/125Ω (100V) 1KΩ/500Ω/250Ω/125Ω/67Ω (70V)
Rated Power	80W
Power Tap	10W/20W/40W/80W (100V) 5W/10W/20W/40W/80W (70V)
SPL	109dB
Size	Φ320*245mm
Weight	5.4kg

